

Medela Dominant Flex Absaugpumpe

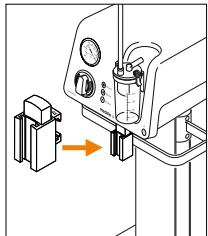

1

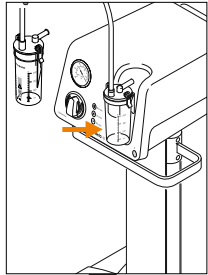
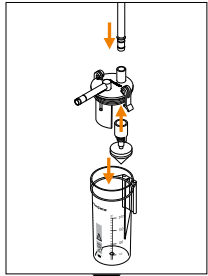

2

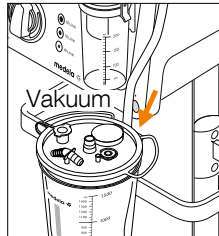
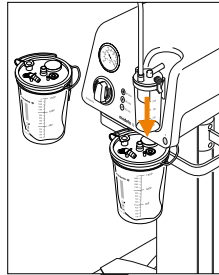
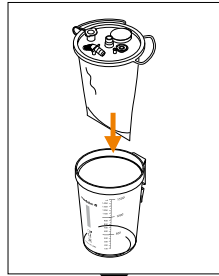

oder

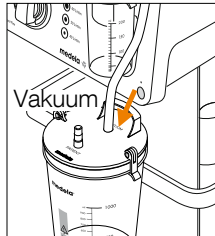
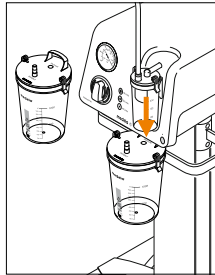
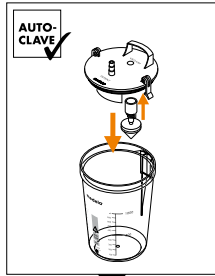

3

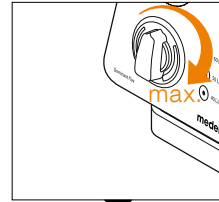
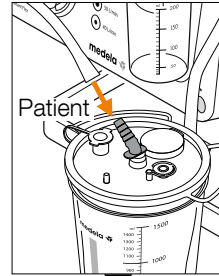

oder

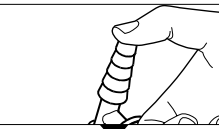
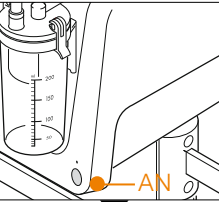
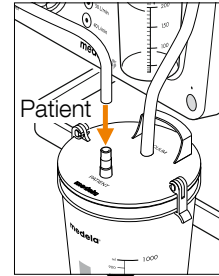

| Meereshöhe | Vakuum | Toleranz +/- 15% |
|------------|----------|------------------|
| + 2000 m | - 72 kPa | - 540 mmHg |
| + 1000 m | - 84 kPa | - 592 mmHg |
| + 500 m | - 89 kPa | - 668 mmHg |
| 0 m | - 95 kPa | - 713 mmHg |

4

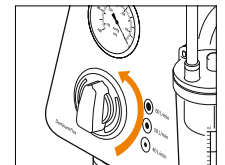

5

oder

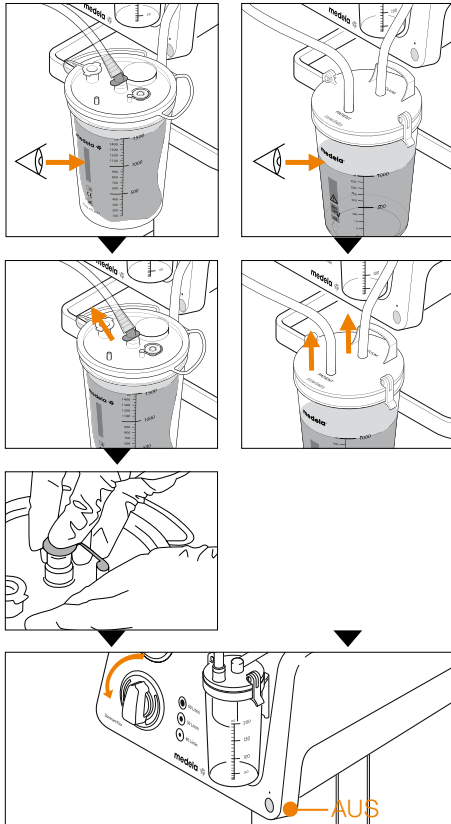

6

oder



CE 0123

Diese Quick Card ersetzt
nicht die Gebrauchsanweisung
REF 200.5522 / 200.5523

 Medela AG
Lättichstrasse 4b
6341 Baar, Switzerland
www.medela.com

Germany & Austria
Medela Medizintechnik
GmbH & Co. Handels KG
Postfach 1148
85378 Eching
Germany
Phone +49 89 31 97 59-0
Fax +49 89 31 97 59 99
info@medela.de
www.medela.de

Precious life – Progressive care